

# NOTICE DE CABLAGE TERMINATION GUIDE

Connecteur RJ45 BC TOOLESS  
BC Toolless RJ45 connector

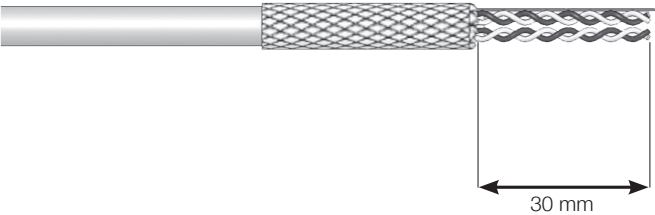

1



Dégainer sur 30 mm  
Strip 30 mm

2

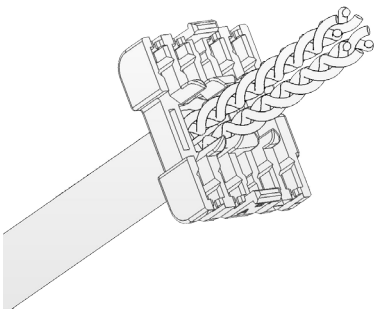

Organiser les fils sur le peigne d'insertion  
Organize wires on the management cap

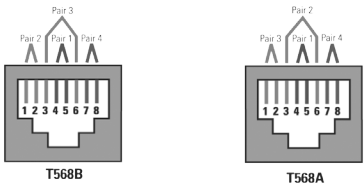

PAIR 1	Blue -White/Blue	Bleu - Blanc/Bleu	PAIR 3	Green – White/Green	Vert – Blanc/Vert
PAIR 2	Orange – White/Orange	Orange – Blanc/Orange	PAIR 4	Brown – White/Brown	Marron – Blanc/Marron

3

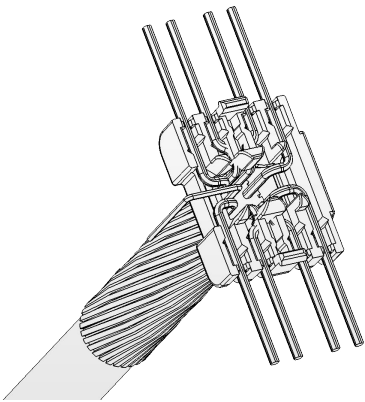

Séparer les fils en fonction du code couleur  
Separate the wires according to colour coding

4

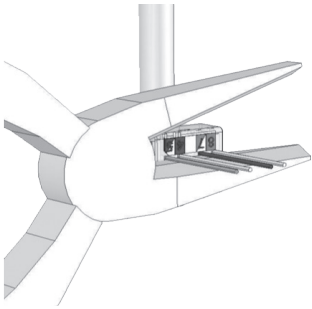

Couper la longueur excessive des brins  
Cut the wires excessive length

5

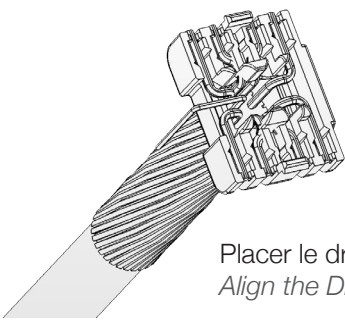

Placer le drain de masse  
Align the Drain Wire

6

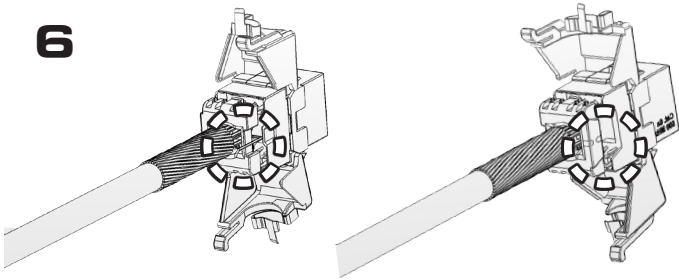

Placer le peigne dans le logement keystone.  
Place Wiring insert in the Keystone Housing, mind  
the alignment of direction.

7

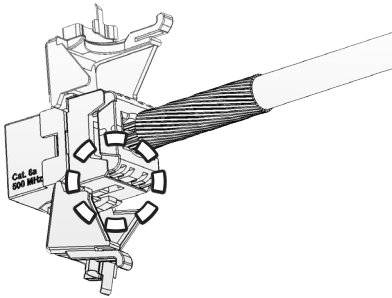

Des attaches maintiennent l'inser de cablage en place.  
A Pre-fixer maintains the wiring insert in place.

8

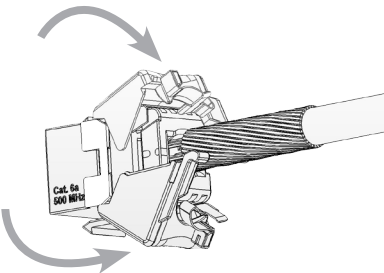

Pour terminer, fermer le capot.  
Close the caps to terminate.

9

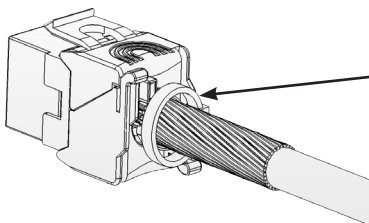

Option : Maintenir la bride à l'aide d'un collier de serrage.  
Hold the flange using a cable tie.



Possibilité d'équiper le connecteur d'un volet antipoussière.  
(plusieurs coloris disponible)  
Possibility to incorporate dust shutter (different colour available)

